

# Cleaning inside of the Document Processor

When using the document processor that features dual scanning, clean the dual scanning unit with the supplied cleaning cloth.

✔ **IMPORTANT**

Do not use thinner or other organic solvents.

- 1 Remove the cloth from the cleaning cloth compartment and open the document processor cover.**

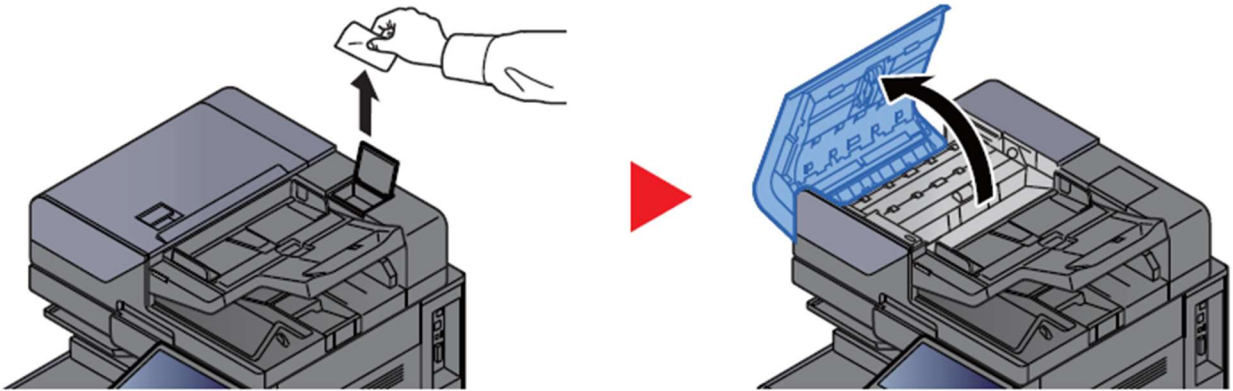

- 2 Clean inside of the document processor.**

